

Idor®
Geolife technology

User Manual

Natural solution for the treatment of septic tanks of up to 3m³ and for domestic drains, such as washbasin siphons and sanitary plumbing



Bioma®

Microbial-enzymatic inoculum

Waste water treatment

Idor® kit composition to treat the equivalent of 5 domestic drains or a septic tank with a volume of no more than 3m³

- **Idor® 1+2** - Microbial-enzymatic mixture - 170 gr
- **Idor® 3** - Liquid activator - 100 ml

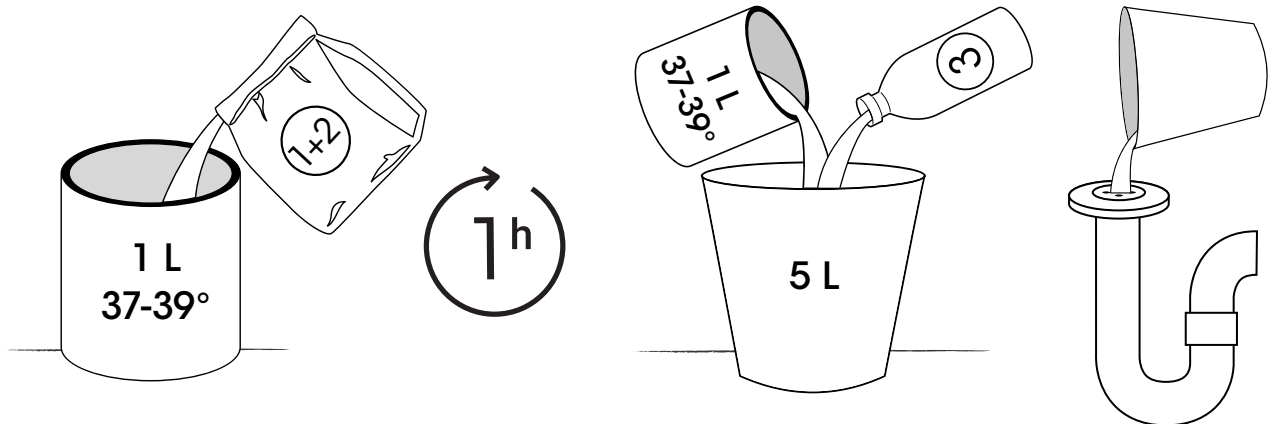

Idor®

- 1.** Dissolve components Idor® 1+2 (powder) in 1 L of clean water at 37-39° C, mix well and let stand for 1 hour (incubation time). This step is necessary to reactivate the microorganisms.
- 2.** At the end of incubation, mix well and pour this solution into 5 L of fresh water and then add liquid component Idor® 3.
- 3.** Pour the preparation into a maximum of 5 domestic drains or into a septic tank with a volume of no more than 3m³.

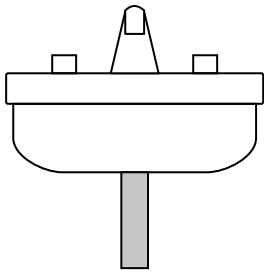

Washbasin

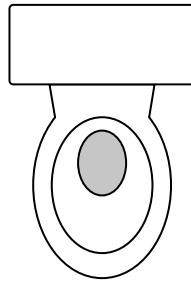

WC

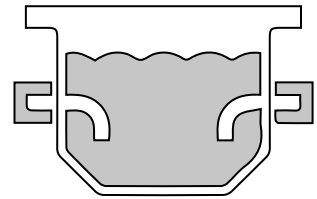

Septic tank



Manufacturer

BIOMA SA

Via Luserte Sud 8
CH - 6572 Quartino

Switzerland

+41 91 840 1015

info@bioma.com

www.bioma.com

